



Digital Loyang Way

3 Loyang Way, Singapore 508719

- MAS Threat Vulnerability Risk Assessment (TVRA) Compliant
- A Singapore BCA Green Mark Platinum Certified Facility
- A Robust, Diversified and Neutral Connectivity Platform



DIGITAL REALTY

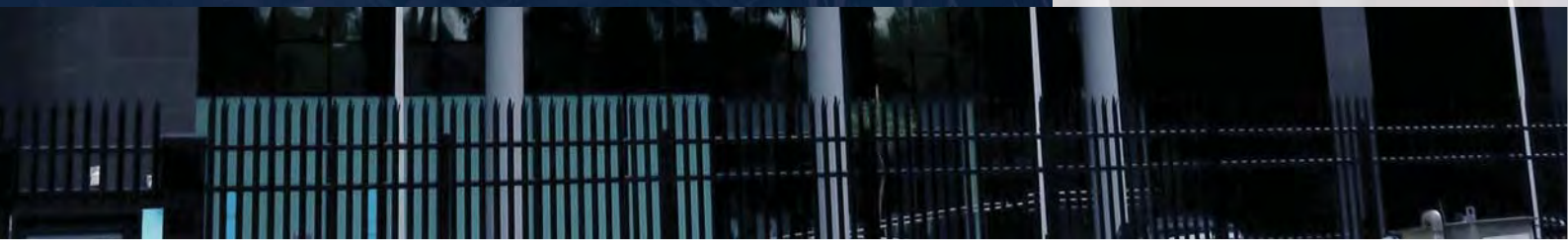

Digital Loyang Way : A Digital Realty Data Centre

THE FACILITY

Located in the northeast of Singapore, Digital Realty's data centre at 3 Loyang Way is a 177,000 sq ft facility supported by a Tier III design. It features a robust power architecture that delivers 13.2 MW of critical IT capacity and provides customers with multi-rack, cage and private suite configurations ranging from 2kW to over 1.2 MW.

The data centre is situated 28 km from Digital Realty's other data centre located at 29A International Business Park (29A IBP), and is 11km from existing Payer Lebar and Serangoon data centre

facilities. Both of these data centre facilities unravel a new strategy for active / active requirements in the city-state.

Digital Realty's 3 Loyang Way data centre offers excellent risk and power diversification and provides the same level of infrastructure quality, service and operational uptime customers have come to expect from Digital Realty's industry leading facilities.

CONNECTIVITY

This premier data centre in the east of Singapore will connect to our data centre in the west via dark and lit fibre services. By leveraging Digital Realty's ecosystem, 3 Loyang Way customers will have access to a carrier neutral and open environment consisting of a wide range of telecommunications providers, service providers and business partners.

Diverse and redundant fibre routes run from outside the facility to fully redundant (2N feeds with 2N generator back-up) Point-of-Presence Rooms (POPs) located within the data centre.

Floor Layout

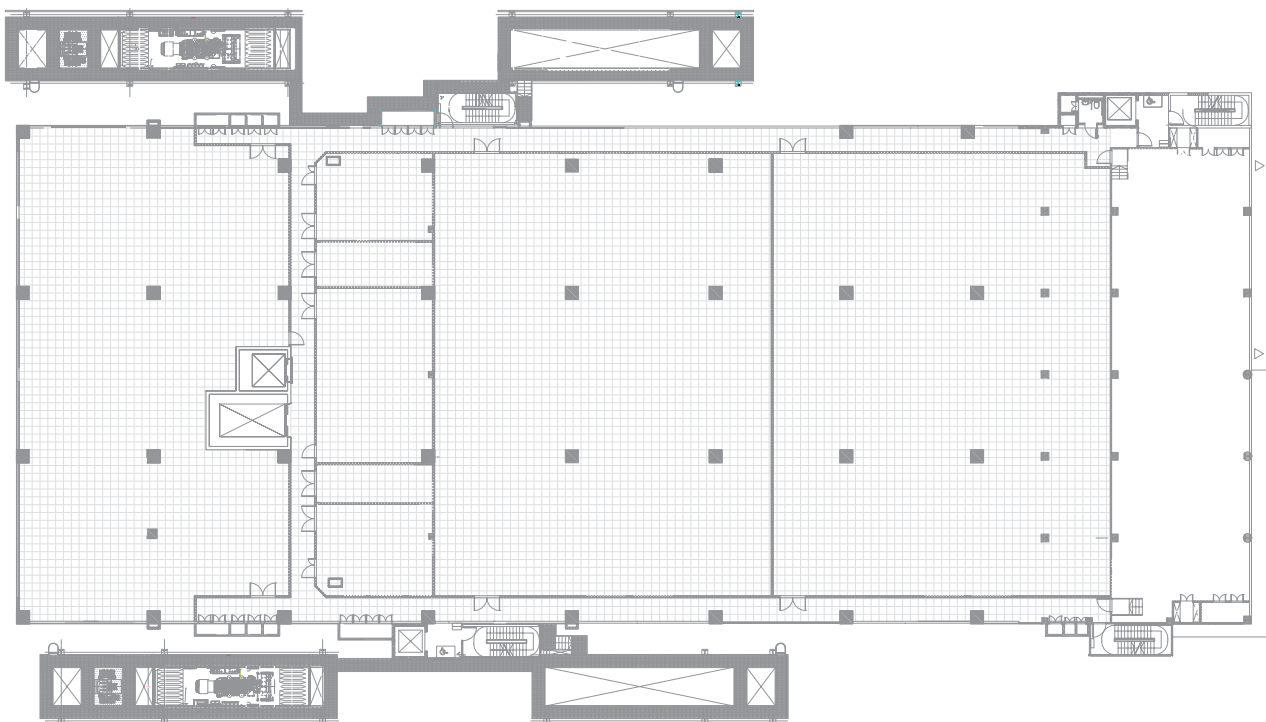

99.999% UPTIME

Digital Realty data centres have achieved “five nines,” or 99.999% uptime for the 10th consecutive year in 2016.

Digital Realty surpassed 1.45 billion operating minutes across its 150+ properties, encompassing approximately 23 million square feet in 33 metropolitan areas around the world.

Uptime metrics are based on a comprehensive evaluation of data centre suites owned and operated by Digital Realty worldwide, using standard industry methodology. These results do not include data centre suites within the eight European facilities acquired by Digital Realty in July 2016. Total operational minutes were prorated per year for each data centre suite, beginning on the commissioning completion date, between 2007 and 2016.



SPECIFICATIONS

DATA SUITE ARCHITECTURE

- 800mm raised floor capable of supporting high density cooling
- 12.5 kN per square metre structural loadings
- 52RU racks compatible

POWER

- Dedicated diverse and redundant 22kV utility power supplies and 22kV power switch rooms
- 13.2 MW total UPS capacity
- Up to 6 HT/LV power transformers in 2N / N+1 Distributed Redundant configuration, providing a total of 6MVA power capacity per floor
- N+1 generator sets per floor
- Fuel storage providing 24-hours of support at full load conditions
- Concurrently maintainable

COOLING

- Floor by floor chillers in N+1 configuration, connected to centralized cooling towers in N+2 configuration
- Quick restart modular magnetic bearing chillers
- Water storage providing 24 hours of support at full load condition
- CRAH corridors per data hall
- Tap off facilities for in-row cooling solutions
- Concurrently maintainable

CONNECTIVITY

- Diverse dark fibre to Digital Realty's 29A IBP data centre, in addition to local carrier connectivity
- Access to global Tier 1 carriers
- Complete access to the Digital Realty Ecosystem
- Diverse and redundant underground entry points to the building
- Diverse and redundant POE (Point of Entry) rooms
- Diverse and redundant POP (Point of Presence) rooms
- Dedicated pathway available to the data centre

SECURITY

- 24/7 onsite security
- 2-factor authentication with biometric access to the data centres
- 24/7 CCTV monitoring with digital recording and 90-day archiving
- Single entrance/exit
- Vehicle crash barrier
- Perimetre fence
- X-ray screening and circular man trap entry



Home of the Digital Cloud

LOCATION

Strategically located in the northeast of Singapore, close to existing and proposed cable landing stations, 3 Loyang Way provides excellent geographical diversification to Digital Realty's data centre in the west of Singapore. Situated within a low risk area, the facility is bounded by Loyang Avenue and Pasir Ris Drive 3.

TRAVEL TIMES

- Singapore CBD 20 min
- Singapore Airport 10 min

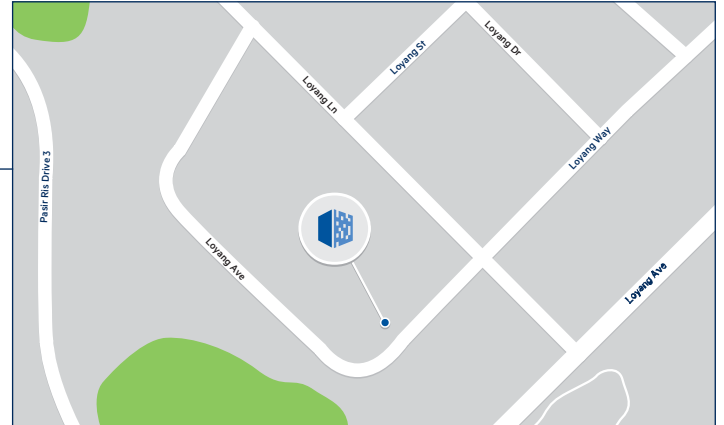

ABOUT DIGITAL REALTY

Digital Realty supports the data centre colocation and interconnection strategies of more than 2,300 firms across its secure, network-rich portfolio of data centres located throughout North America, Europe, Asia and Australia. Digital Realty's clients include domestic and international companies of all sizes, ranging from financial services, cloud and information technology services, to manufacturing, energy, gaming, life sciences and consumer products.
www.digitalrealty.asia

CONTACT

- T +65 6505 3900
E Contact.APAC@digitalrealty.com
W www.digitalrealty.asia



VR 360 Tour

Scan the QR code above with your mobile device and have a tour of our facilities today.



DIGITAL REALTY